

New fine-tuning possibilities.

The Corner bass trap is the latest in low frequency absorption. This elegant panel integrates a tuneable membrane over a sealed volume, containing a high performance acoustic core. A secondary compartment positions Helmholtz resonators in the high pressure zone of the room. The panel is completely tuneable, by means of an adjustable weighted membrane, allowing to pin-point the performance of the panel to a target frequency.

The panels' tuneable membrane works in a similar way to a speaker cone, allowing for a much superior - and controlled - performance. A central mass is supported by an elastic membrane - This mass can then be altered to change the resonant frequency of the membrane, stepping the peak performance of the Trap from 58 to 82 Hz.

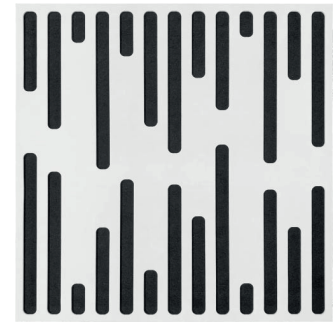

**Performance**

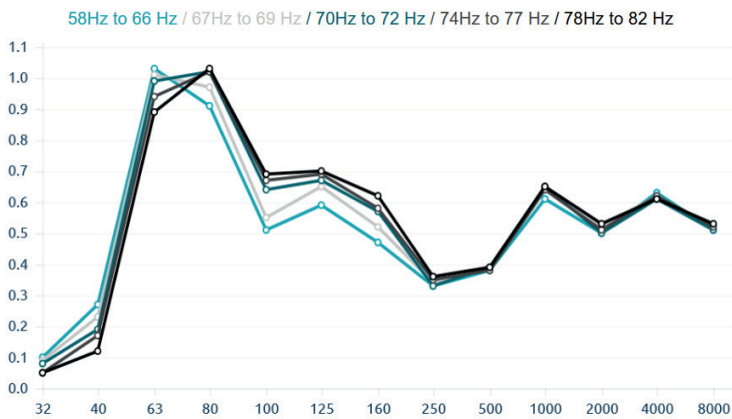

**Features**

Type:  
 †.P.D.A. - Artnovion technology  
 †uneable Pistonic Diaphragmatic Absorber  
 †uneable absorption range: 58Hz to 82Hz.

.Tuneable weighted Diaphragmatic membrane  
 .Hz-by-Hz fine tuning  
 .New fine-tuning possibilities.

Material:  
 - Acoustic fabric | Natural Wood veneer | Lacquered HMDF  
 - Marine grade plywood structural frame  
 - Calibrated cell acoustic foam

This panels can only be installed on vertical wall corners. Not for ceiling use.

**Technical Information**

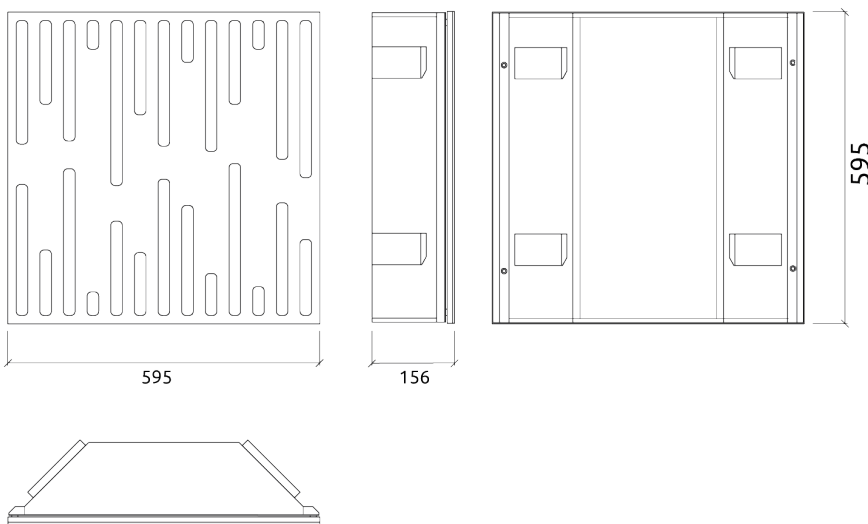

**Dimensions:**

FG - LW | 595x595x156mm  
 FG - NW | 595x595x156mm

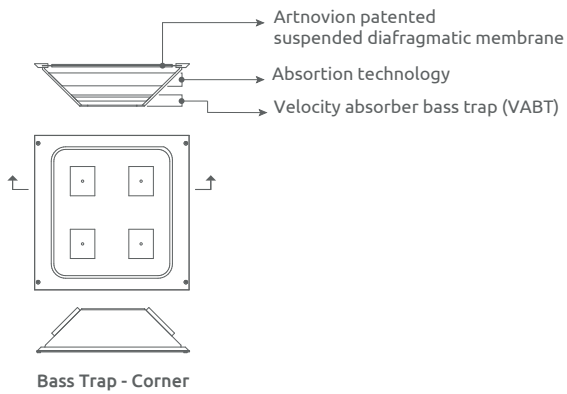

Fine-tuning possibilities

- [ 58 Hz  
66 Hz ]
- [ 67 Hz  
69 Hz ]
- [ 70 Hz  
72 Hz ]
- [ 74 Hz  
77 Hz ]
- [ 78 Hz  
82 Hz ]



#### Purpose

- Room mode control
- Bass ratio control
- Low frequency RT reduction
- Improving low frequency response
- Reducing low frequency time decay

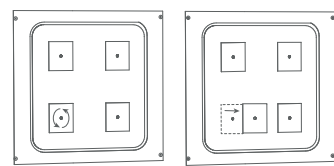

**1** Select the weight layout to tune the bass trap to your desired frequency range.

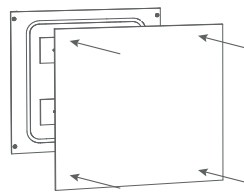

**2** Clip the front of the panel in to the bass trap body, leaving easy access to the membrane.

#### Recommended for

- Control Room
- Recording Room
- Home Studio
- Broadcast Studio
- Production Room
- Drum Room

### Corner Bass Trap performance

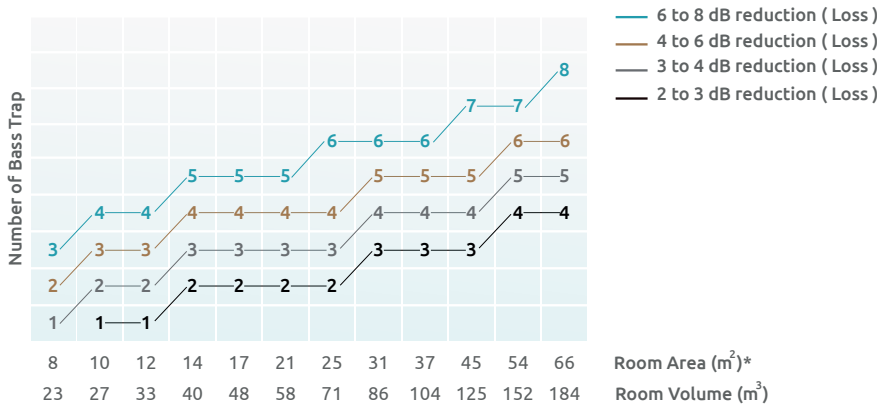

\* Ceiling height from 2,7 to 3m

### Fixing System

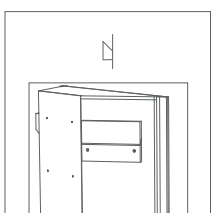

Integrated fixing system

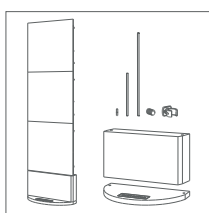

Kit Mobile Wall

Product finishes

(FG - LW) Lacquered Wood Finishes



(L01) Blanc



(L02) Noir



(L03) Rouge



(L05) Silver



(L06) Noir Vintage



(L07) Graphite  
Black



(L08) Rose Gold



(L09) Classic Gold



(L10) Bronze



(L11) Raw White



(L12) Raw Black

(FG - NW) Natural Wood Finishes



(W01) Cerise



(W02) Marron



(W03) Wenge

